

YASKAWA

MOTOMAN GP FGG-series

Handling & General Application
for the Food Industry



**GP4 FGG, GP7 FGG, GP8 FGG, GP12 FGG, GP25 FGG
and GP50 FGG:**

Increase Productivity

**Highest payloads, speeds and wrist allowable
moment in its class**

- A variety of workpieces can be transferred and different grippers can be mounted of with payloads up to 50 kg
- Acceleration/deceleration control has been improved to achieve maximum reduction of acceleration/deceleration times for all robot postures

Make Equipment compact

Slim and easy-to-use structure

- Slim robot body requires minimum installation space (minimizes L-U axis offset)
- The manipulator cable can be connected at the bottom section, which reduces interference with walls and requires far less installation space when compared with cable connections on the side of the robot
- Increased maximum reach and horizontal reach enables robots to operate in wider work areas
- The slim, straight, and symmetrical arm design minimize interference with peripheral devices even in small spaces

KEY BENEFITS

- Food grade grease allows robot to be used in food related applications in secondary and tertiary packaging
- Drip proof design assures smooth disposal of a liquid on the robot surface

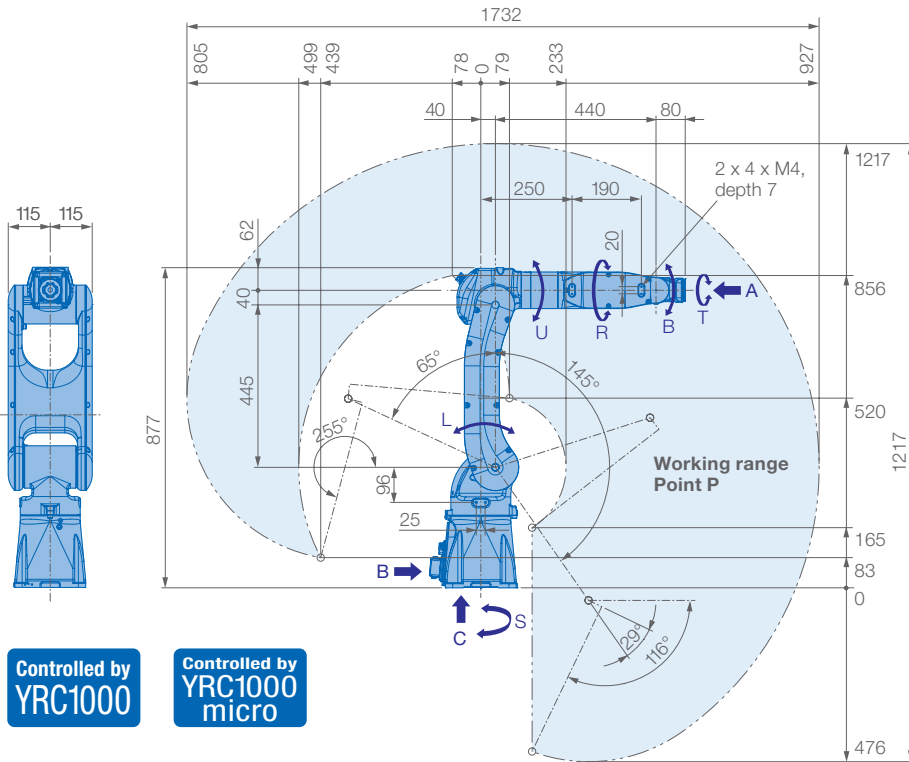

Controlled by YRC1000

Controlled by YRC1000 micro

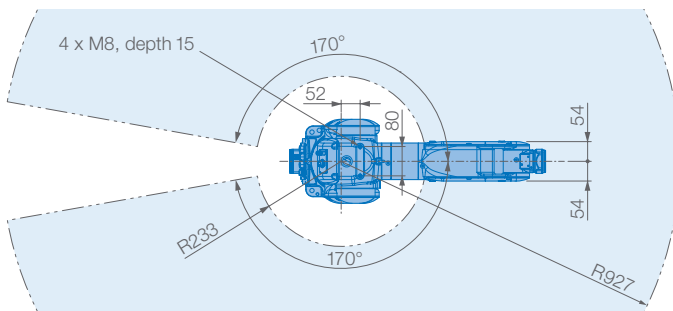

View A

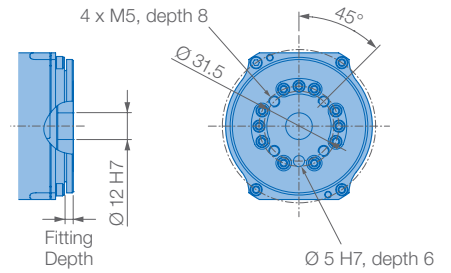

View B

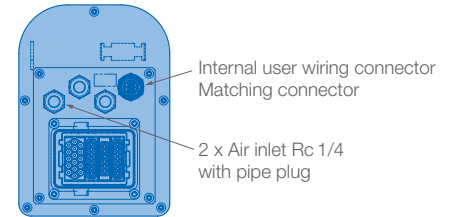

View C

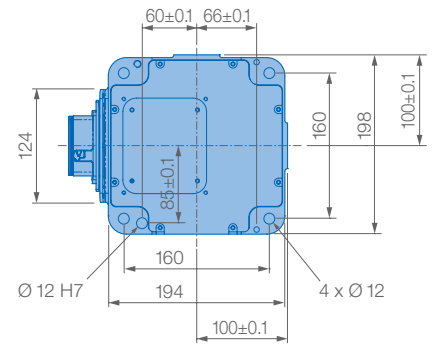

Mounting options: Floor, ceiling, wall, tilt*

Protection class: IP67

* tilt with condition of angle – see table below

Prevent interaction of the robot with:

- Corrosive gasses, liquids or explosive gasses
- Exposure to water, oil or dust
- Excessive electrical noise (plasma)

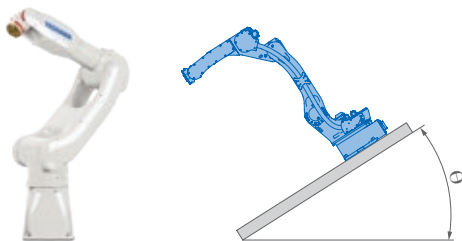

Allowable wrist load

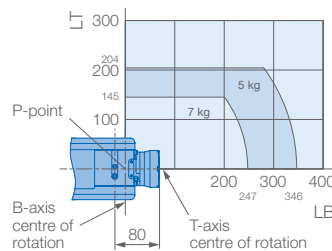

| Robot installation angle Θ [deg.] | S-axis operating range [deg.] |
|--|--------------------------------------|
| $0 \leq \Theta \leq 30$ | ± 170 degrees or less (no limit) |
| $30 < \Theta \leq 35$ | ± 60 degrees or less |
| $35 < \Theta \leq 40$ | ± 50 degrees or less |
| $40 < \Theta \leq 45$ | ± 45 degrees or less |
| $45 < \Theta \leq 50$ | ± 40 degrees or less |
| $50 < \Theta \leq 60$ | ± 35 degrees or less |
| $60 < \Theta$ | ± 30 degrees or less |

Specifications GP7 FGG

| Axes | Maximum motion range [°] | Maximum speed [°/s] | Allowable moment [Nm] | Allowable moment of inertia [kg · m ²] | Controlled axes | |
|------|--------------------------|---------------------|-----------------------|--|-----------------------------|--------------|
| S | ± 170 | 375 | – | – | Max. payload [kg] | 6 |
| L | +145/–65 | 315 | – | – | Repeatability [mm] | 7 |
| U | +190/–70 | 410 | – | – | Max. working range R [mm] | $\pm 0.01^*$ |
| R | ± 190 | 550 | 17 | 0.5 | Temperature [°C] | 927 |
| B | ± 135 | 550 | 17 | 0.5 | Humidity [%] | 0 to +45 |
| T | ± 360 | 1000 | 10 | 0.2 | Weight [kg] | 20 – 80 |
| | | | | | Power supply, average [kVA] | 37 |
| | | | | | | 1** |

* Conforms to ISO 9283 ** Varies in accordance with applications and motion patterns Note: SI units are used for specifications.

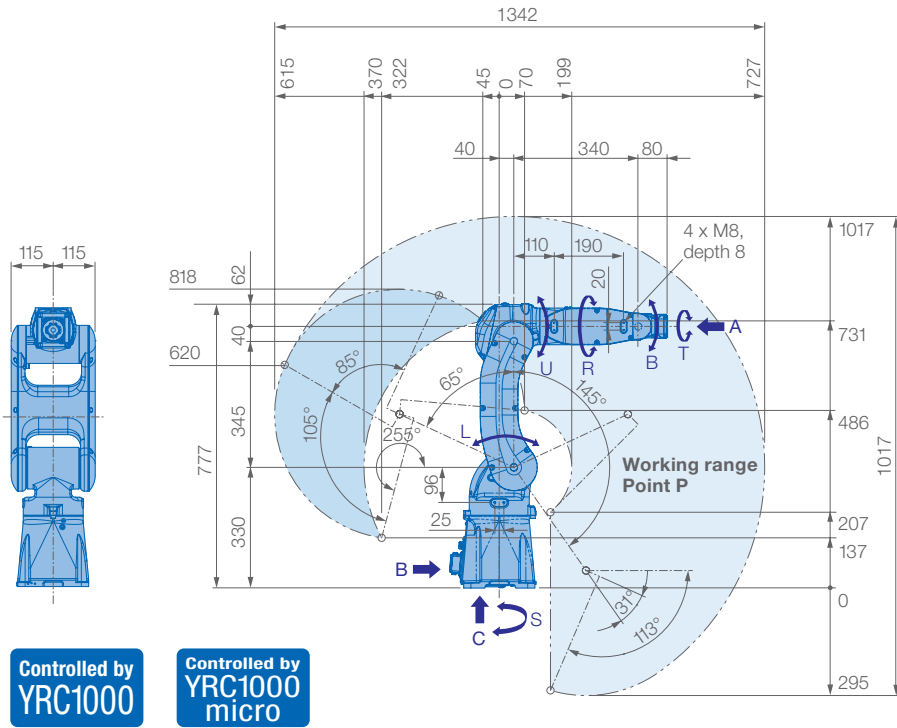

View A

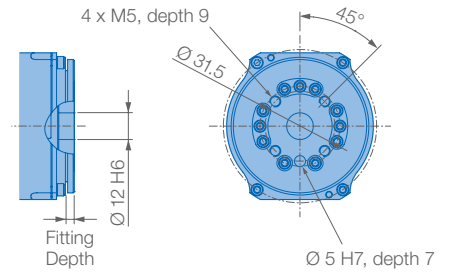

View B

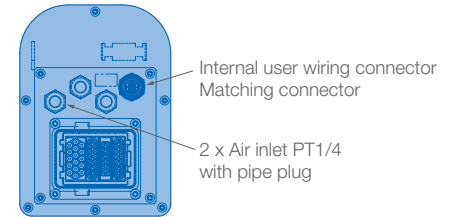

View C

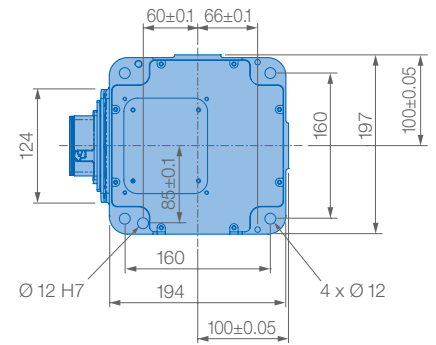

Mounting options: Floor, ceiling, wall, tilt*

Protection class: IP67

* tilt with condition of angle – see table below

| Robot installation angle θ [deg.] | S-axis operating range [deg.] |
|--|--------------------------------------|
| $0 \leq \theta \leq 30$ | ± 170 degrees or less (no limit) |
| $30 < \theta \leq 35$ | ± 60 degrees or less |
| $35 < \theta \leq 40$ | ± 50 degrees or less |
| $40 < \theta \leq 45$ | ± 45 degrees or less |
| $45 < \theta \leq 50$ | ± 40 degrees or less |
| $50 < \theta \leq 60$ | ± 35 degrees or less |
| $60 < \theta$ | ± 30 degrees or less |

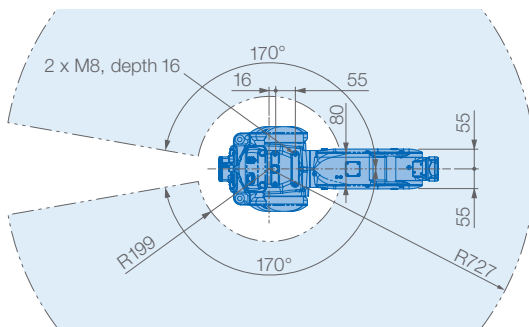

Prevent interaction of the robot with:

- Corrosive gasses, liquids or explosive gasses
- Exposure to water, oil or dust
- Excessive electrical noise (plasma)

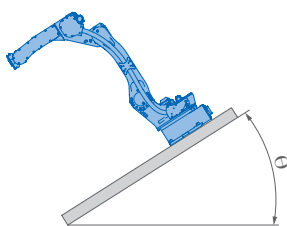

Allowable wrist load

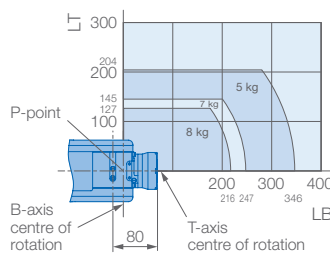

Specifications GP8 FGG

| Axes | Maximum motion range [°] | Maximum speed [°/s] | Allowable moment [Nm] | Allowable moment of inertia [kg · m ²] | Controlled axes | |
|------|--------------------------|---------------------|-----------------------|--|-----------------------------|--------------|
| S | ± 170 | 455 | – | – | Max. payload [kg] | 6 |
| L | +145/–65 | 385 | – | – | Repeatability [mm] | 8 |
| U | +255/–113 | 520 | – | – | Max. working range R [mm] | $\pm 0.01^*$ |
| R | ± 190 | 550 | 17 | 0.5 | Temperature [°C] | 727 |
| B | ± 135 | 550 | 17 | 0.5 | Humidity [%] | 0 to +45 |
| T | ± 360 | 1000 | 10 | 0.2 | Weight [kg] | 20 – 80 |
| | | | | | Power supply, average [kVA] | 35 |
| | | | | | | 1** |

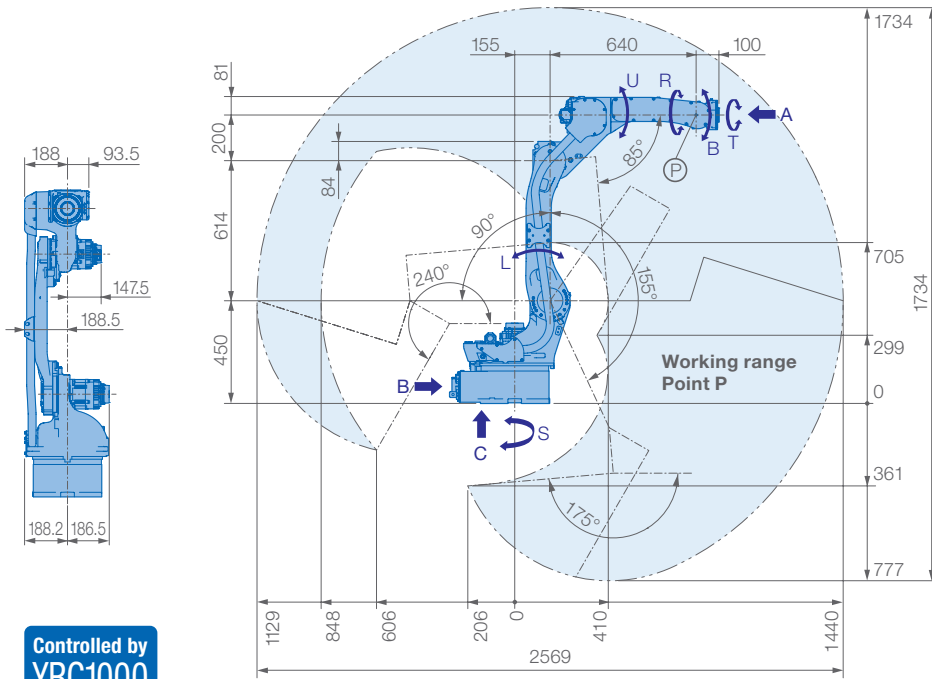

View A

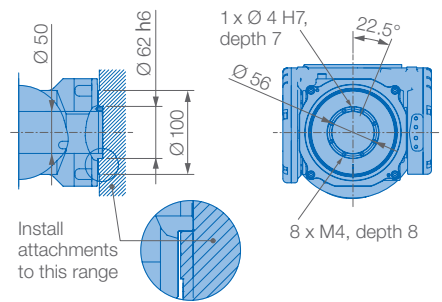

View B

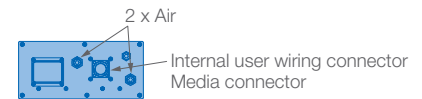

View C

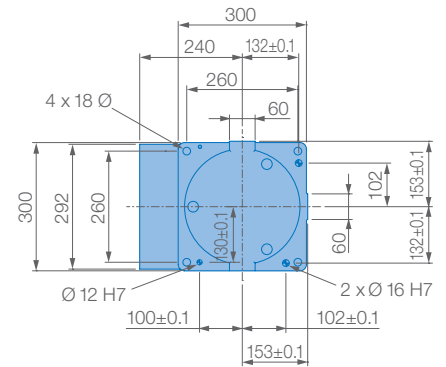

Mounting options: Floor, ceiling, wall, tilt*

Protection class: IP67

* tilt with condition of angle – see table below

| Roboter-Neigungswinkel Θ [Grad] | S-Achsen-Arbeitsbereich [Grad] |
|--|--|
| $0 \leq \Theta \leq 30$ | ± 170 max. Neigungswinkel (keine Beschränkung) |
| $30 < \Theta \leq 35$ | ± 60 max. Neigungswinkel |
| $35 < \Theta \leq 45$ | ± 45 max. Neigungswinkel |
| $45 < \Theta$ | ± 30 max. Neigungswinkel |

Controlled by YRC1000

Controlled by YRC1000 micro

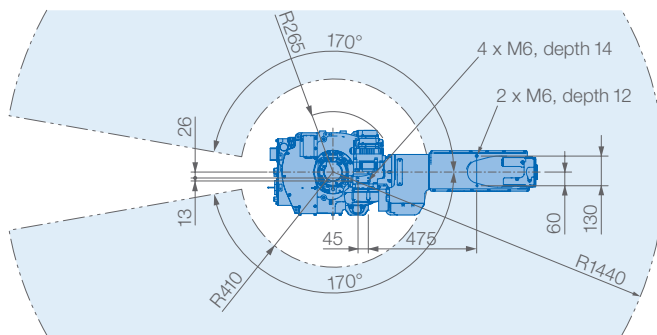

Prevent interaction of the robot with:

- Corrosive gasses, liquids or explosive gasses
- Exposure to water, oil or dust
- Excessive electrical noise (plasma)



Allowable wrist load

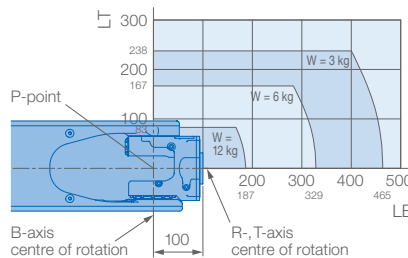

Specifications GP12 FGG

| Axes | Maximum motion range [°] | Maximum speed [°/s] | Allowable moment [Nm] | Allowable moment of inertia [kg · m ²] | Controlled axes | 6 |
|------|--------------------------|---------------------|-----------------------|--|-----------------------------|--------------|
| S | ± 170 | 260 | – | – | Max. payload [kg] | 12 |
| L | +155/-90 | 230 | – | – | Repeatability [mm] | $\pm 0.02^*$ |
| U | +155/-85 | 260 | – | – | Max. working range R [mm] | 1440 |
| R | ± 200 | 470 | 22 | 0.65 | Temperature [°C] | 15 to +45 |
| B | ± 150 | 470 | 22 | 0.65 | Humidity [%] | 20 – 80 |
| T | ± 455 | 700 | 9.8 | 0.17 | Weight [kg] | 155 |
| | | | | | Power supply, average [kVA] | 1,5** |

* Conforms to ISO 9283 ** Varies in accordance with applications and motion patterns Note: SI units are used for specifications.

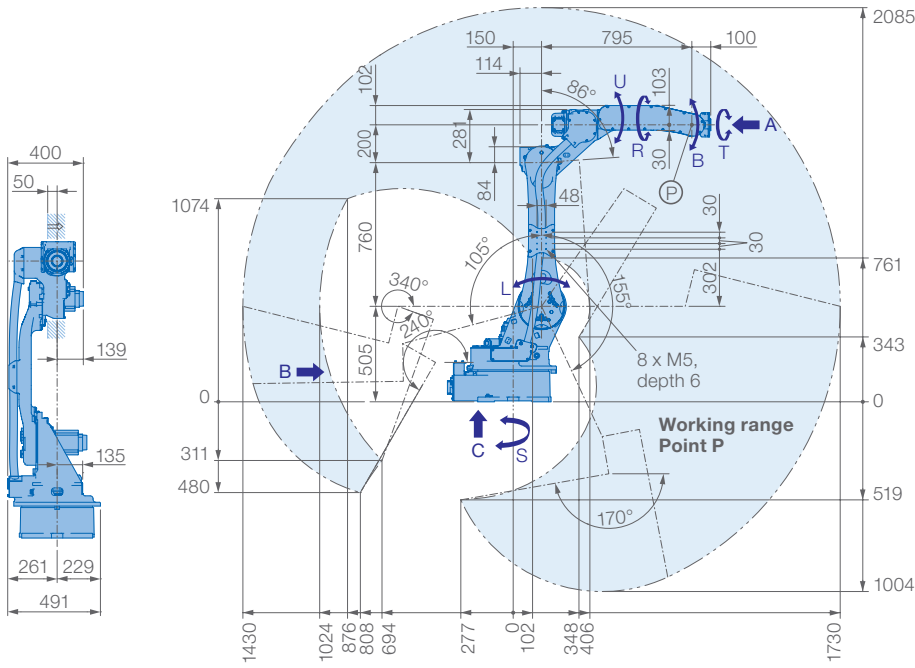

View A

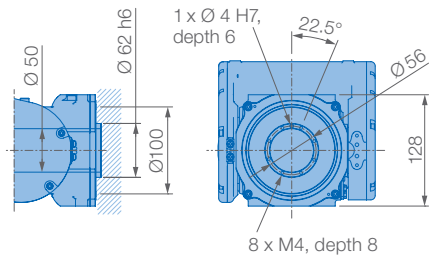

View B

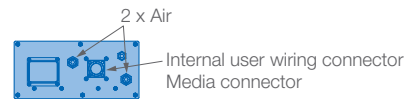

View C

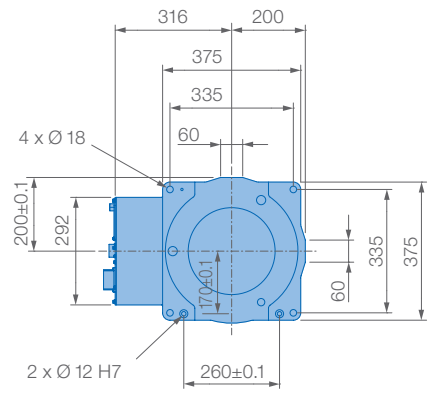

Mounting options: Floor, ceiling, wall, tilt*
 Protection class: IP65/67
 * tilt with condition of angle – see table below

| Robot installation angle Θ [deg.] | S-axis operating range [deg.] |
|--|--------------------------------------|
| $0 \leq \Theta \leq 30$ | ± 180 degrees or less (no limit) |
| $30 < \Theta \leq 35$ | ± 60 degrees or less |
| $35 < \Theta$ | ± 30 degrees or less |

Controlled by YRC1000

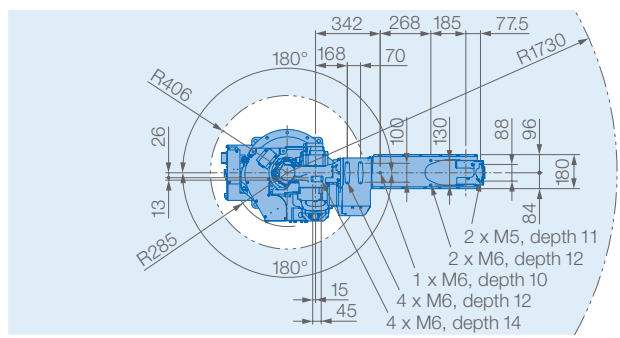

Prevent interaction of the robot with:

- Corrosive gasses, liquids or explosive gasses
- Exposure to water, oil or dust
- Excessive electrical noise (plasma)



Allowable wrist load

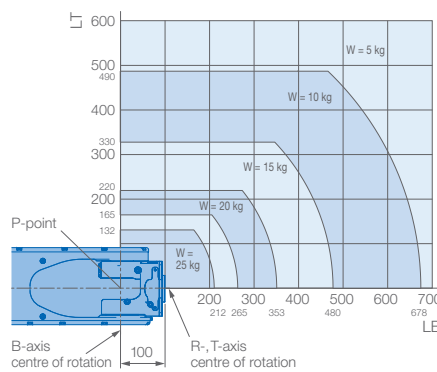

| Specifications GP25 FGG | | | | | | |
|-------------------------|--------------------------|---------------------|-----------------------|--|-----------------------------|--------------|
| Axes | Maximum motion range [°] | Maximum speed [°/s] | Allowable moment [Nm] | Allowable moment of inertia [kg · m ²] | Controlled axes | 6 |
| S | ± 180 | 210 | – | – | Max. payload [kg] | 25 |
| L | +155/–105 | 210 | – | – | Repeatability [mm] | $\pm 0.02^*$ |
| U | +160/–86 | 265 | – | – | Max. working range R [mm] | 1730 |
| R | ± 200 | 420 | 52 | 2.3 | Temperature [°C] | 15 to +45 |
| B | ± 150 | 420 | 52 | 2.3 | Humidity [%] | 20 – 80 |
| T | ± 455 | 885 | 32 | 1.2 | Weight [kg] | 265 |
| | | | | | Power supply, average [kVA] | 2,0** |

* Conforms to ISO 9283 ** Varies in accordance with applications and motion patterns Note: SI units are used for specifications.

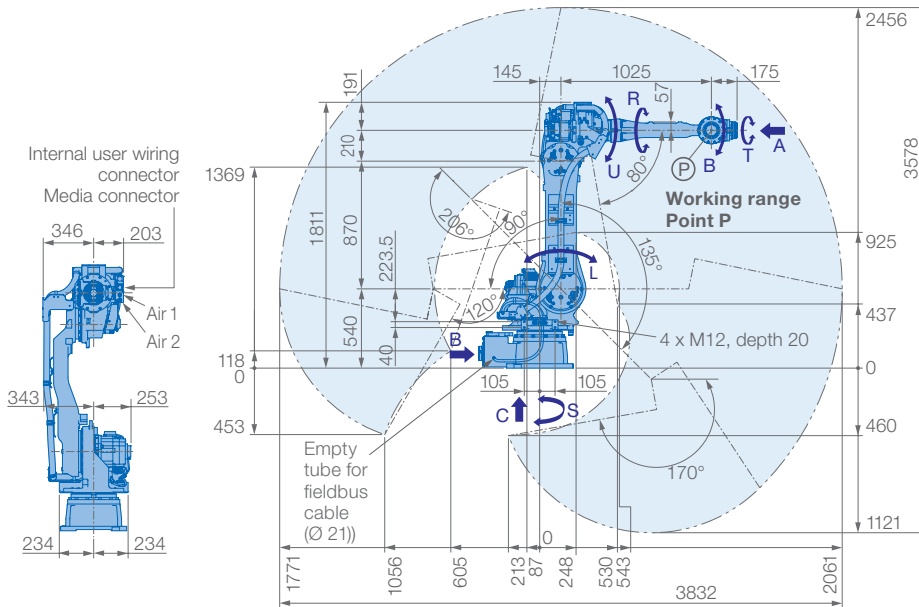

View A

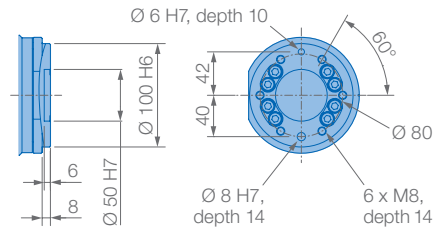

View B

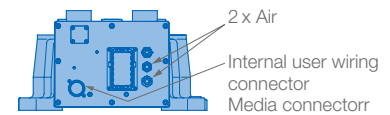

View C

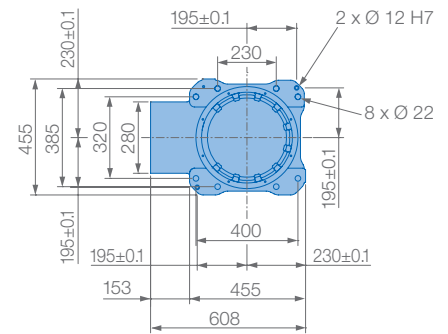

Mounting options: Floor, ceiling, wall, tilt*

Protection class: IP67

* tilt with condition of angle – see table below

| Robot installation angle θ [deg.] | S-axis operating range [deg.] |
|--|-------------------------------|
| $0 \leq \theta \leq 30$ | ± 180 (Standard) |
| $30 < \theta \leq 35$ | ± 60 |
| $35 < \theta \leq 45$ | ± 45 |
| $45 < \theta$ | ± 30 |

Controlled by YRC1000



Prevent interaction of the robot with:

- Corrosive gasses, liquids or explosive gasses
- Exposure to water, oil or dust
- Excessive electrical noise (plasma)

Allowable wrist load

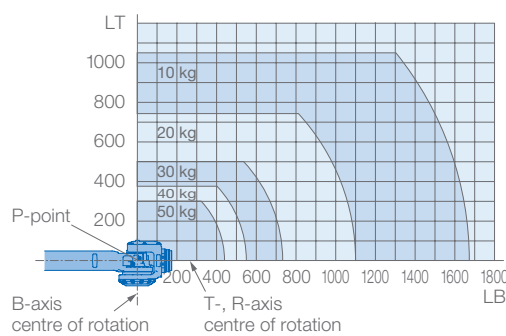
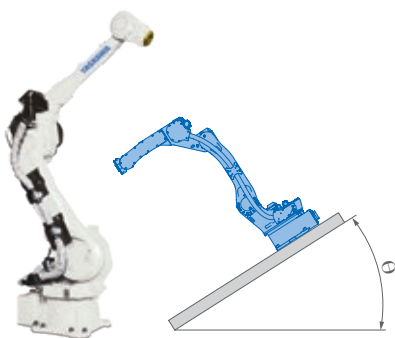

Specifications GP50 FGG

| Axes | Maximum motion range [°] | Maximum speed [°/s] | Allowable moment [Nm] | Allowable moment of inertia [kg · m ²] | Controlled axes | 6 |
|------|--------------------------|---------------------|-----------------------|--|-----------------------------|------------|
| S | ± 180 | 180 | – | – | Max. payload [kg] | 50 |
| L | $+135/-90$ | 178 | – | – | Repeatability [mm] | ± 0.03 |
| U | $+206/-80$ | 178 | – | – | Max. working range R [mm] | 2061 |
| R | ± 360 | 150 | 216 | 28 | Temperature [°C] | 15 to +45 |
| B | ± 125 | 150 | 216 | 28 | Humidity [%] | 20 – 80 |
| T | ± 360 | 200 | 147 | 11 | Weight [kg] | 585 |
| | | | | | Power supply, average [kVA] | 4.0 |

YASKAWA GROUP

- AT Yaskawa Austria
Schwechat/Wien
+43(0)1-707-9324-15
- CZ Yaskawa Czech s.r.o.
Rudná u Prahy +420-257-941-718
- DK Yaskawa Danmark
Løsning +45 7022 2477
- ES Yaskawa Ibérica, S.L.
Gavà/Barcelona +34-93-6303478
- FR Yaskawa France SARL
Le Bignon +33-2-40131919
- FI Yaskawa Finland Oy
Turku +358-(0)-403000600
- GB Yaskawa UK Ltd.
Banbury +44-1295-272755
- IT Yaskawa Italia s.r.l.
Torino +39-011-9005833
- IL Yaskawa Europe Technology Ltd.
Rosh Ha'ayin +972-3-9004114
- NL Yaskawa Benelux B.V.
Eindhoven +31-40-2895500
- PL Yaskawa Polska Sp. z o.o.
Wrocław +48-71-7928670
- RU Yaskawa Europe Holding AB
Moskva +46-480-417-800
- SE Yaskawa Nordic AB
Torsås +46-480-417-800
- SI Yaskawa Slovenia
Ribnica +386-1-8372-410
- TR Yaskawa Turkey Elektrik
Ticaret Ltd. Sti.
İstanbul +90-216-5273450
- ZA Yaskawa Southern Africa (PTY) Ltd
Johannesburg +27-11-6083182

DISTRIBUTORS

- BG ATRI ROBOTICS Ltd.
Stara Zagora +359 899 625 160
Kammarton Bulgaria Ltd.
Sofia +359-02-926-6060
- EE RKR Seadmed OÜ
Tallinn/Estonia +372-68-35-235
- GR Gizelis Robotics
Schimatari Viotias +30-2262057199
- HU Flexman Robotics Kft
Budapest +36 1 259 0981
- LT Profibus UAB
Panevezys +370-45-518575
- NO Skala Robotech AS
Lierstranda +47-32240600
- PT ROBOPLAN Lda
Aveiro +351-234 943 900
- RO NORMANDIA S.R.L.
Braşov +40 268 549 236



Yaskawa Headquarters

Yaskawa Europe GmbH
Robotics Division
Yaskawastraße 1
85391 Allershausen, Germany
Tel. +49 (0) 8166/90-0
Fax +49 (0) 8166/90-103

Yaskawa Academy and sales office Frankfurt

Yaskawa Europe GmbH
Robotics Division
Hauptstraße 185
65760 Eschborn, Germany
Tel. +49 (0) 6196/77725-0
Fax +49 (0) 6196/77725-39

All drawing dimensions in mm.
Technical data may be subject to change without previous notice.
Please request detailed drawings at robotics@yaskawa.eu.

YR-1-06VX4-F00, YR-1-06VX7-F40, YR-1-06VX8-F40,
YR-1-06VXH12-F00, YR-1-06VXH25-F40, YR-1-06VX50-F00
GP FGG-series

F-03-2022, A-Nr. 190839